

DIA .56
[14]
(4 PLACES)

TAP 11/16
(4 PLACES)

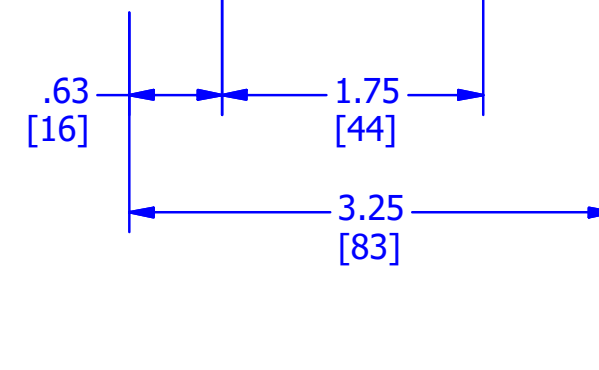
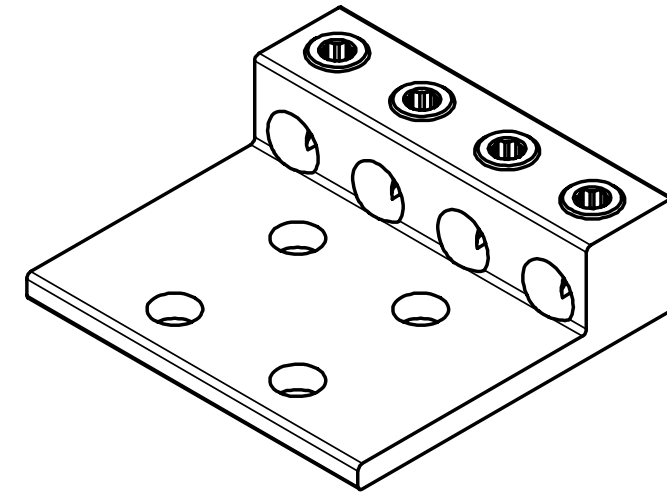
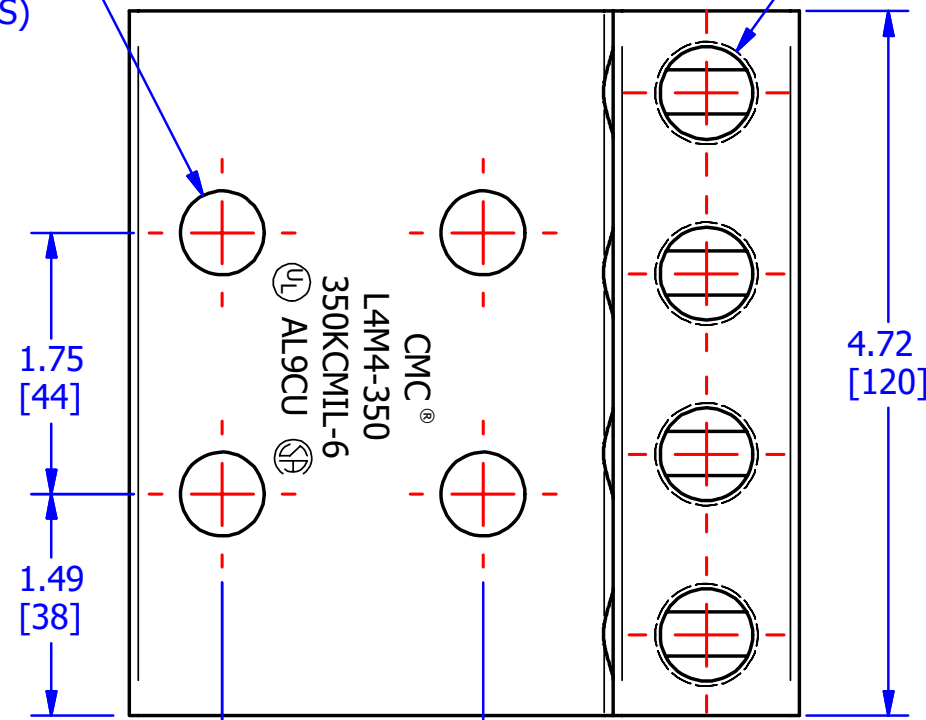

SCREWS ARE SUPPLIED WITH
CONNECTOR AND COMES
FULLY ASSEMBLED.

FINISH: TIN PLATE
MATERIAL: ALUMINUM

					TO ORDER CMC PRODUCTS CALL 1-513-860-4455	DRAWN BY: TS 03/06/18	NAME OF PART: 4 BARREL LUG	CAT. NO.: L4M4-350
					FOR PRODUCT INFO: http://www.cmclugs.com	CHECKED BY:	DWG NO: C00494046-S	A
A	NEW DRAWING CREATED		03/06/18	TS		DRAWING NOT TO SCALE		SHEET NO: 1 OF 1

THIS INFORMATION IS PROPRIETARY TO CONNECTOR MFG. CO. AND IS NOT TO BE DISCLOSED OUTSIDE OF CONNECTOR MFG. CO. WITHOUT A CONFIDENTIALITY AGREEMENT



CONNECTOR MANUFACTURING CO.

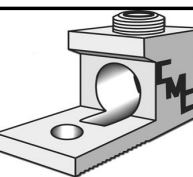

HAMILTON, OHIO